

## 24' x 40' OFFICE SMS-N-40-3W

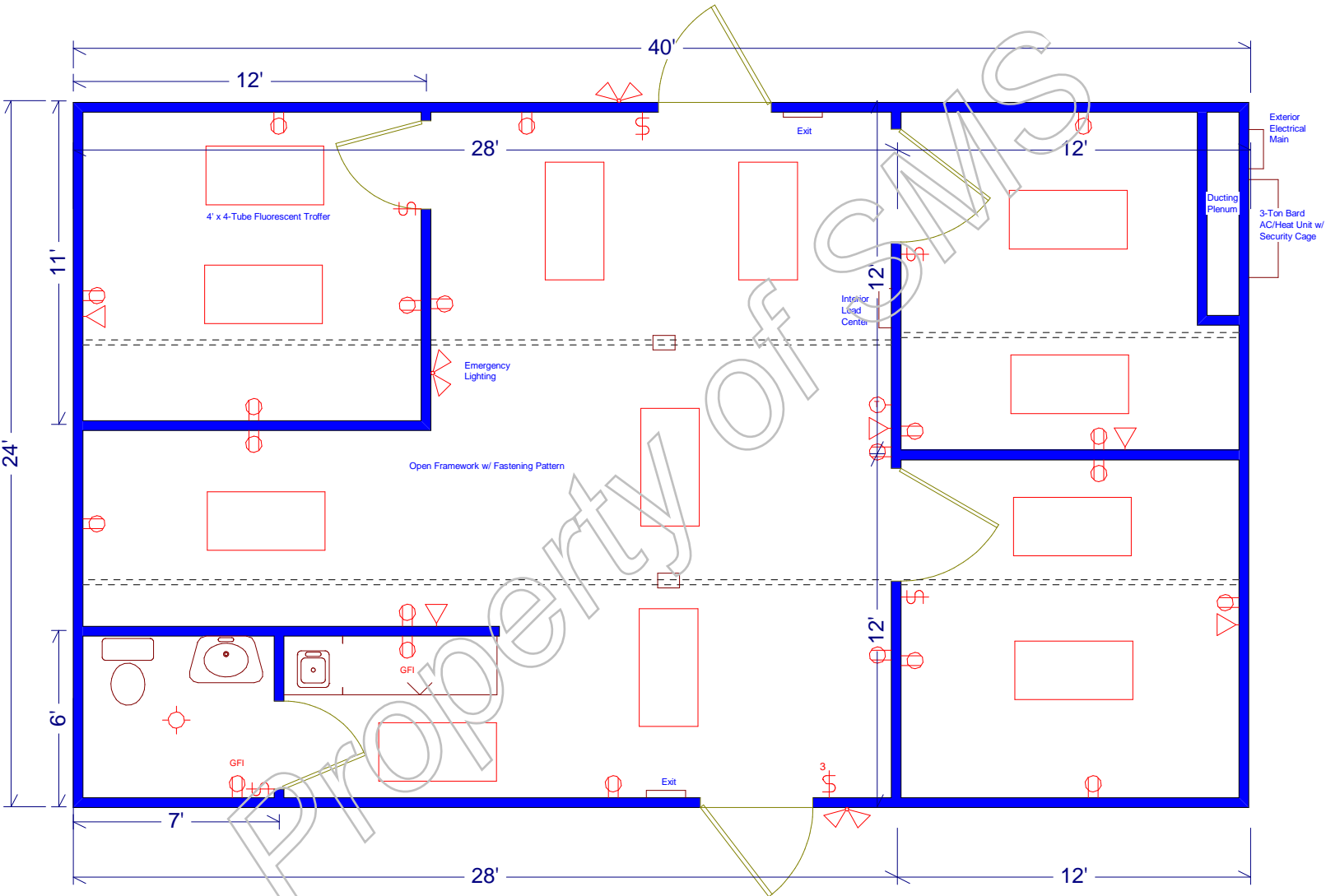

- 1.) Finished Interior (Storage & Work Room) To Consist Of: 1.5" Foam Insulation, Acoustic Ceiling, & VCT Flooring.
- 2.) Install 1" Spray Foam Under Floor
- 3.) Central Ducting With Security Registers, Returns, & Thermostat
- 4.) Exit Signs On All Egress Doors
- 5.) Replace Original Cargo doors w/ 16-Gauge Steel